

ModulBox[®] Classic

SIGNAGE - Light Box

400

Edge-lit solution that
brings you savings
you can rely on

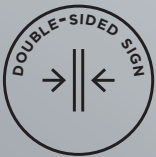
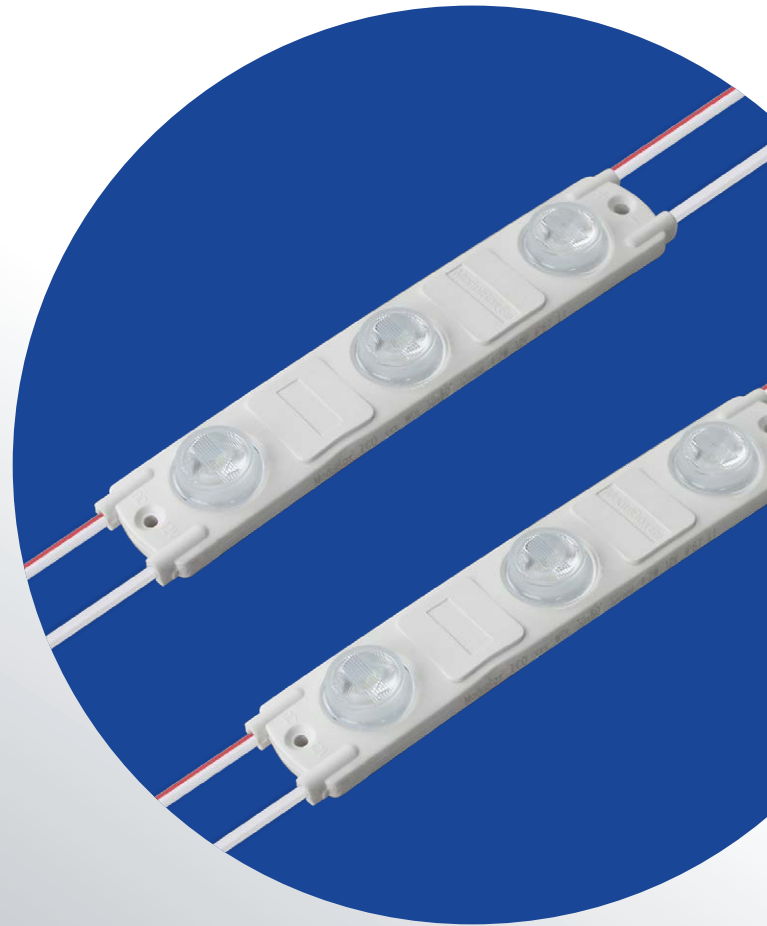

5 YEARS
50.000hrs
L50

- High efficiency (over 100 lm/W)
- IP67 and UV-protected
- Choose between 3 White CCTs
- Two optics available

ModulBox[®] Classic SIGNAGE - Light Box

400



5 YEARS
50,000hrs
L50



IP67



10°x40°
30°x60°



10 MOD. MAX
IN SERIES



CUTTABLE
EVERY 1 MOD.



NO NEED



12V



11 TO 17V
REGULATOR

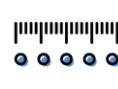

6 TO 3
MOD. / ML



10 TO 4
MOD. / M2



-30°/+55°C

TECHNICAL DATA

Code	Designation	Color Temperature / Wavelength	Typical power / mod (W)	Lumen output (lm/mod.)	Efficiency (lm/W)	Mod/chain	Mod distance - axe to axe (mm / in)
21820357	ModulBox Classic 400 WDL 10x40° 10mod 4.2W 12V IP67	○ WDL 6000-6500K	4,2	430	102	10	370±5/14,6"
21820358	ModulBox Classic 400 NW 10x40° 10mod 4.2W 12V IP67	○ NW 3500-4000K	4,2	410	98	10	370±5/14,6"
21820359	ModulBox Classic 400 WW 10x40° 10mod 4.2W 12V IP67	○ WW 2600-3100K	4,2	410	98	10	370±5/14,6"
21820360	ModulBox Classic 400 WDL 30x60° 10mod 4.2W 12V IP67	○ WDL 6000-6500K	4,2	400	95	10	370±5/14,6"
21820361	ModulBox Classic 400 NW 30x60° 10mod 4.2W 12V IP67	○ NW 3500-4000K	4,2	380	90	10	370±5/14,6"
21820362	ModulBox Classic 400 WW 30x60° 10mod 4.2W 12V IP67	○ WW 2600-3100K	4,2	380	90	10	370±5/14,6"

DIMENSIONS

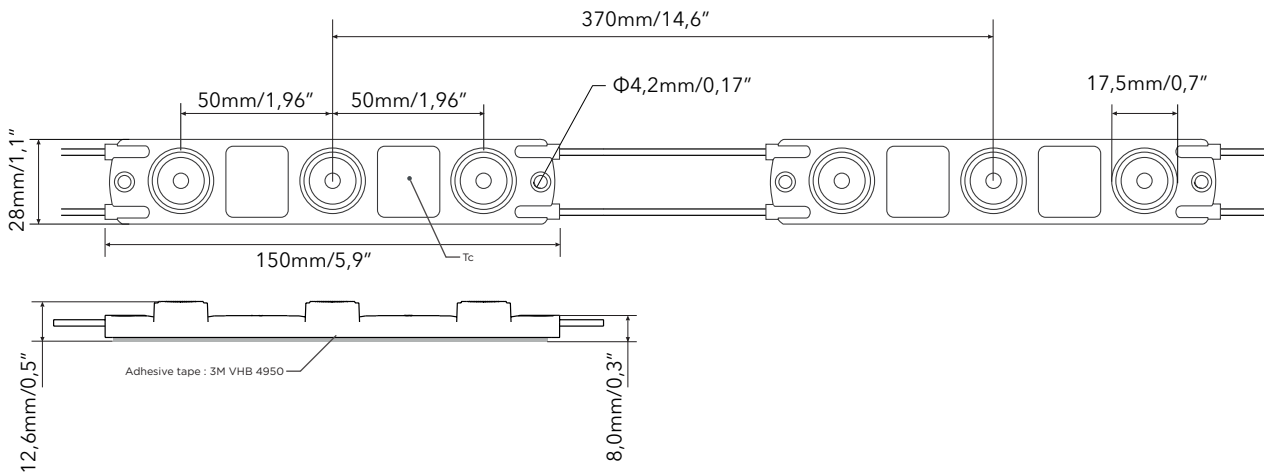

WIRING DIAGRAM

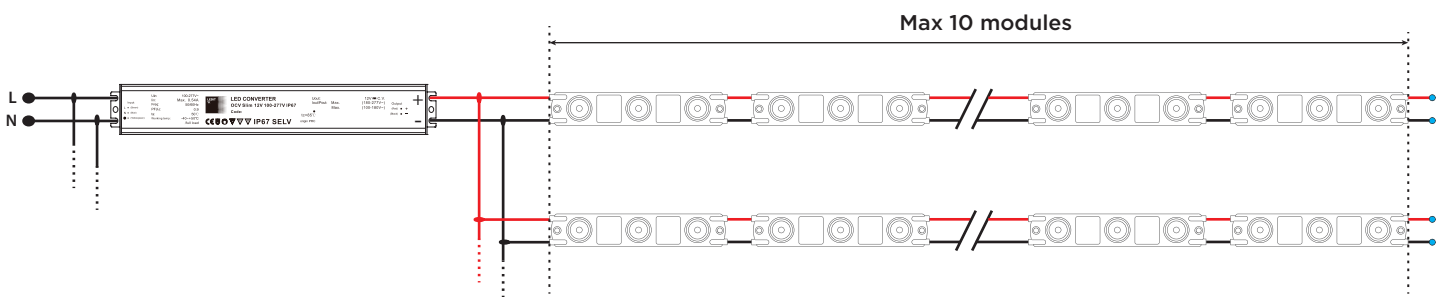

ModulBox® Classic SIGNAGE - Light Box

400

APPLICATION - Edge lighting- 10x40° optics

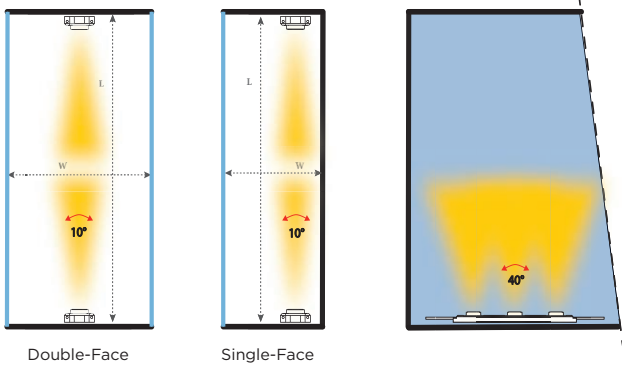
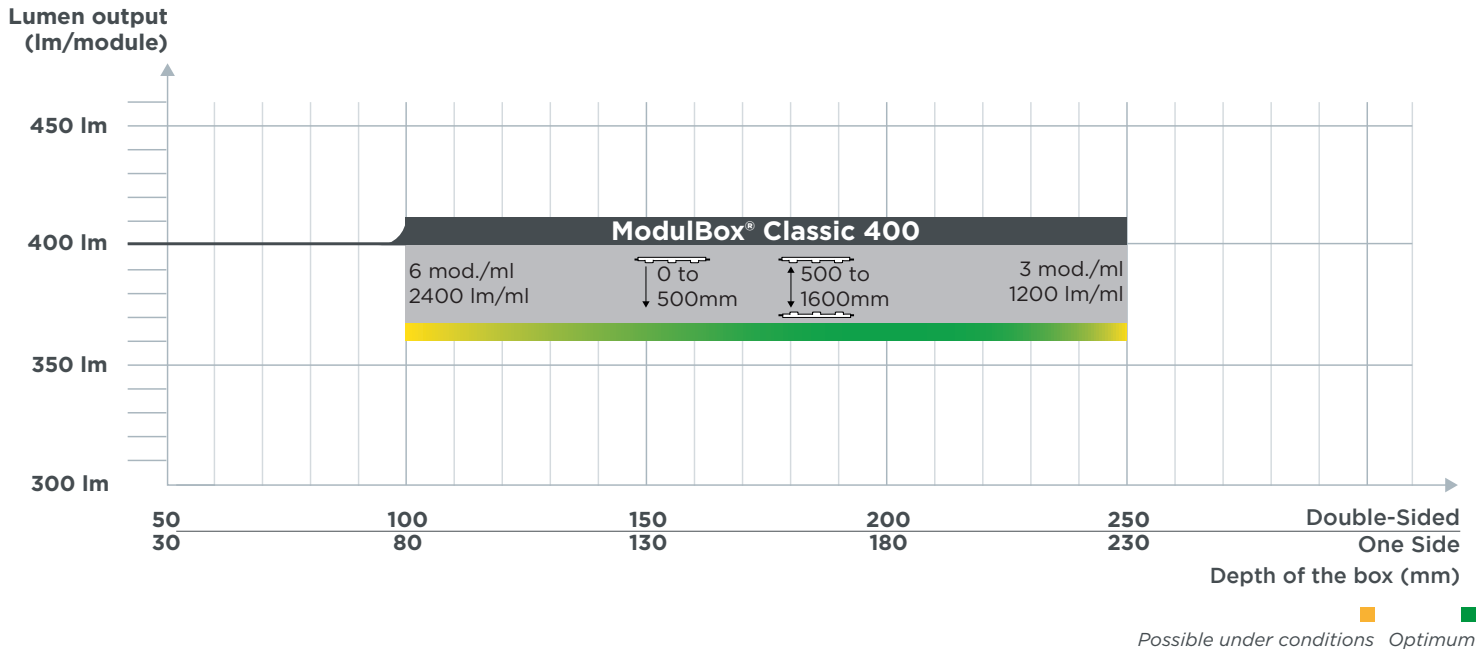

On double-sided boxes, place the modules in the center of the sign box.
On single-face sign boxes, place the modules at 10mm of the box back.

APPLICATION - Linear front lighting - 30x60° optics

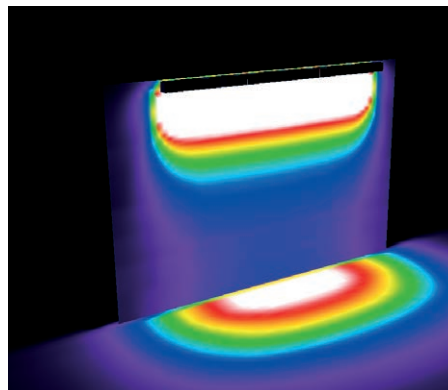
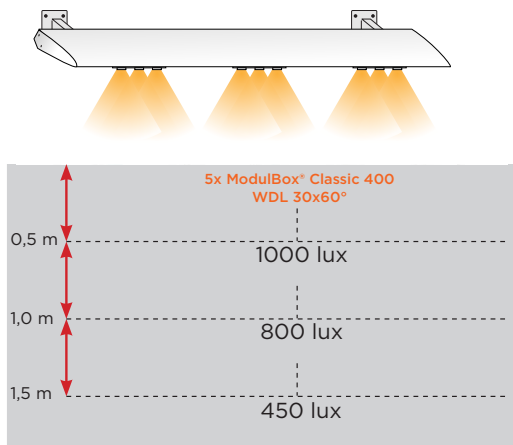

*Dialux simulation with 3 meters linear engine equipped with 15 ModulBox® Classic 400 WDL 30x60°

INSTALLATION

- ▶ Always connect the LED modules to the power supply while it is OFF. Only then you can connect the power supply to electricity and turn it ON.
- ▶ Respect the maximum number of modules in a row.
- ▶ Check compatibility between LED and driver voltage.
- ▶ Install LED on a clean work station connected to the earth. All LEDs are sensitive to static electricity (ESD).
- ▶ Limit the cable length between LED and power supply (voltage drop).
- ▶ Do not make direct pressure on LED chip, this could damage the internal connection.
- ▶ Secure LED module lines with mechanical fixation (screws, glue, etc...) in addition to the adhesive tape.

INGRESS PROTECTION IP67

“Inbuilt LED module” for Indoors or Outdoors.

The specified environmental protection of the LED module enclosure means that it is protected against dust ingress and water immersion up to 1m deep.

The certification requires products to pass a test 30min long at 1m depth. After 30min of submersion, the product could start to be affected or damaged.

Make sure that the application of the LED modules has proper drain holes for water to exit so that modules and any other electronic component are not submerged exceeding the IP67 certification limits.

NORMS & CERTIFICATES

- ▶ EN 55015:2013
- ▶ EN 61547:2009
- ▶ EN61000-3-2:2014
- ▶ EN61000-3-3:2013



THERMAL BEHAVIOUR

The temperature limits indicated below are expressed in °C, at full load, after 3h of operation conditions, with natural convection:

- ▶ Operation temperature Ta -20°C to +50°C
- ▶ Storage temperature Ts -20°C to +60°C
- ▶ Max. temperature Tc point +90°C

The life of the module will decrease when the maximum temperature limits are exceeded.

Operating for a continuous extended time at temperatures exceeding the maximum limits, the modules can fail and our warranty will be void.

IDENTIFICATION

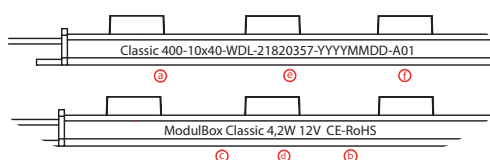

- a. Product name
- b. CE/RoHS logo
- c. Product designation
- d. Module consumption
- e. Product code
- f. Batch number

WHITE TOLERANCE

In order to ensure there is no color difference visible to the human eyes, tolerance of LEDs are Macadam ellipse 5 for white LEDs.

FAILURE RATE

Our LED system has a max failure rate of 0.2% per 1000 operating hours.

PACKAGING

Types	SIZE - LxWxH (cm)	SIZE - LxWxH (ft)	Weight (kg)	Weight (lb)	Units (chain)
ModulBox Classic 400	41,5x35x18,5	1,4x1,1x0,6	12,86	28,4	20

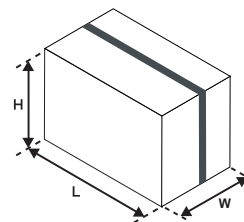

(When the min and max values are not indicated, the tolerance range for optical and electrical data is ±15 %.)